



**MUSIC AT
LEAMINGTON
HASTINGS**

**2 0 1 3
SEASON**

Brochure

Music at Leamington Hastings

(Reg Charity No 1121192)

Concerts 2013

May 25th 7.30pm Saturday Kammer Philharmonie Europa

June 8th 7.30pm Saturday Atea Wind Quintet

June 9th 3.00pm SUNDAY Warwickshire Baroque MATINEE

July 14th 7.30pm SUNDAY Yehudi Menuhin School Orchestra

Sep 7th 7.30pm Saturday Martin Kasik (piano)

Oct 12th 7.30pm Saturday St Petersburg String Quartet

Dec 7th 7.00pm Saturday Ex Cathedra

Tickets (excluding Matinee)

All seats are reserved.

Terms and Conditions are on back of the booking form

Standard

Throughout the church:
£8 + £8 donation = £16

Youth

Under 18:
1st £2 + £8 donation = £10
2nd (and more) in one party are FREE

Chancel

Standard price, except when there are singers - only at Dec
£4 + £8 donation = £12

Season

6 concerts for less than cost of 5
£38 + £40 donation = £78

Refreshments are served gratis at all these concerts - either wine/soft drinks or Strawberries and cream in Summer or mulled wine at Christmas

Please let us know if you are interested in our Patron scheme – influencing the future and helping to preserve this unique place.

Matinee

Tickets are £8 each, Children £2 (includes tea/soft drinks) - **NO RESERVED SEATS**

The booking form is in the middle pages of this brochure, as are the terms & conditions that apply



Welcome to the 42nd Season of Music at Leamington Hastings

Dear Music Lover,

As the first snows of 2013 fall, I am beginning to look forward to the summer, and our concert series, and reflecting on 2012, which brought many fine performances and a growth in audience numbers.

After a successful 2012, I have pleasure in presenting the series for 2013. We have some old favourites, the Yehudi Menuhin School Orchestra and Ex Cathedra, and some newcomers. We have music that you may not have heard before, for example with the Atea wind quintet (who are giving a UK premier), as well as some of the great classics including Borodin's 2nd String quartet, one of the most popular of all string quartets, played by the St. Petersburg quartet.

Martin Kasik is a fine international pianist, and it is surprising we have not had him before at our concerts. I am even now looking forward to Mussorgsky's Pictures at an Exhibition, more famous in its orchestral rendering, but also a wonderful work for solo piano, which should sound marvellous in the acoustics of All Saints.

We start with a substantial programme by the Kammer Philharmonie Europa, a young orchestra, which being of chamber orchestra size allows us to hear pieces beyond the scope of smaller ensembles including a trumpet concerto, and finishing with the ever-popular and fresh Holberg Suite by Grieg. It will be interesting to compare them with the Yehudi Menuhin School, appearing in July. In June, on the day after the Saturday Concert we have a Sunday Matinee concert featuring a local orchestra, Warwickshire Baroque. The season closes with an opportunity to hear the world-class singing of Ex Cathedra.

I would, finally, like to give special thanks to the people who have contributed to the smooth running and success of the concerts, and who made a commitment to set aside their time to help manage them. A roster of names, and there are many, appears toward the end of this brochure

With every good wish for 2013,



David Potts

Concert 1

May 25th / Saturday 7.30pm



Kammer Philharmonie Europa

The Chamber Philharmonic of Europe was founded in 2006 in Cologne and engages over 60 of the most talented young musicians from 18 European nations. Its outstanding high artistic level was confirmed by press and critics at the many concerts and festivals where the orchestra played throughout the continent

Since its inception the Chamber Philharmonic Europe has been built upon a broad range of professional experience. In the interest of promoting the younger generation, the orchestra aims also to provide promising artists the opportunity for further development in its various sections. It is from this principle that the Chamber Philharmonic Europe is able to produce a creative working atmosphere which inspires the ensemble with great motivation.

PROGRAMME

- | | | |
|---------------|---|--|
| A. VIVALDI | - | Concerto for Violin No.4 in A minor |
| A. PONCHIELLI | - | Concerto in F Major, for trumpet and orchestra |
| J. S. BACH | - | Double Concerto For Two Violins In D Minor |

INTERVAL A glass of wine or juice will be served to you in your seats during the interval

- | | | |
|------------|---|--------------------------------------|
| A. CORELLI | - | Concerto Grosso Op.6 No.4 in D Major |
| G. FAURE | - | Pavane Op. 50 |
| E. GRIEG | - | Holberg-Suite Op.40 |

Concert 2

June 8th Saturday 7.30pm



Atéa Wind Quintet

Anna Hashimoto - Clarinet
Ashley Myall - Bassoon
Christopher Beagles - Horn
Philip Haworth - Oboe
Alena Lugovkina - Flute

The Atéa Wind Quintet is a UK-based ensemble formed in 2009 comprised of recent graduates from the Royal Academy of Music, Royal College of Music, and Guildhall School of Music and Drama.

They have performed in venues throughout the UK, including the Cambridge Summer Music Festival.

Members of the group have performed with many of the UK's Leading Orchestras, including, English National Opera, English Chamber Orchestra,

Orchestra of Opera North, English Concert Orchestra, London Sinfonietta, Royal Liverpool Philharmonic Orchestra, with other Orchestras further afield such as New Japan Philharmonic Orchestra, Verbier Festival Orchestra, Symphony Orchestra of India and Bahrain Symphony Orchestra.

They have devised an extremely engaging programme for us, with elements from the classical period to the present day, all befitting a warm summer evening - one can but hope the weather will do its part!

PROGRAMME

JOSEPH HAYDN - Opus 42 in D minor arr. Geoffrey Emerson
JEFF MANOOKIAN - Wind quintet
SAMUEL BARBER - Summer Music

INTERVAL Weather permitting, Strawberries and cream will be served outdoors

GIULIO BRICCIALDI - Wind Quintet no.1 op. 124
PAQUITO D'RIVERA - Aires Tropicales
JOHANN STRAUSS - Damen-Souvenir-Polka arr. Michael Totzauer

Concert 3 - Sunday Matinee

June 9th Sunday Afternoon 3.00pm

Warwickshire Baroque Players

Directed by
Eddie Jones



Talented musicians, teachers and amateurs, have formed together to be able to play music from the baroque era. The group started in the early 1990s as an offshoot of the Bedworth Orchestra to enable a small group of good players to have a quality playing experience in a different style from the orchestra's repertoire.

As time progressed the group gradually became North Warwickshire Baroque and attracted players from further afield.

Regular concerts were started around the Nuneaton area and a pattern of monthly rehearsals was established. A change of address in 2000 for director Eddie Jones to the centre of Warwickshire meant that contact was now possible with players from south of the county as well. The decision was taken to move the rehearsal base to the Wolston/Ryton area, and drop the "North" from the group name to reflect more accurately the county-wide spread membership.

PLEASE NOTE THAT THERE ARE NO RESERVED SEATS FOR THIS CONCERT, THOUGH YOU MAY PHONE TO BUY TICKETS IN ADVANCE.

PROGRAMME

"Handel and Friends"

The theme is the music of Handel and composers who met, influenced, or even lent Handel music (unknowingly in most cases!)

This varied concert will include pieces by HANDEL - TELEMANN - CORELLI - SCARLATTI (arr.. Avison, who was, by the way, a native of Newcastle on Tyne)

Concert 4

July 14th Sunday 7.30pm - Note Sunday date



Yehudi Menuhin School Orchestra

Directed by

Malcom Singer

This orchestra of wonderful young players appears at our church again before going off to perform at engagements on the continent. There are important anniversaries coming up relating to the School - their 50th anniversary - and on the day before this concert Malcolm Singer's 60th Birthday.

The programme spans the mid-18th to the late 20th century. The Mozart and the Bach are familiar works, but not so much so that we should forget what superb pieces they are. Alongside these, we have more modern pieces. The name Schönberg can inspire dread, but unnecessarily so, particularly in the case of *Verklärte Nacht* ("Transfigured Night"), which is more reminiscent of the late-Romantics than the atonal music of Schoenberg's later period. The violin concerto by the Latvian Pēteris Vasks was composed during 1996-7 for the violinist Gidon Kramer. It often bears the title "Distant Light", pointing towards Vasks' own idea, permeating his works, that music should offer consolation and spiritual solace.

PROGRAMME

to include

A.SCHÖNBERG	-	Verklärte Nacht,
W.A. MOZART	-	Eine Kleine Nachtmusik,
J.S. BACH	-	Violin Concerto in A minor
P. VASKS	-	Violin concerto

Weather permitting, Strawberries and cream will be served outdoors

Concert 5

September 7th Saturday 7.30pm

Martin Kasik is an outstanding young Czech pianist. Born in 1976, he has been playing the piano since the age of four. He has won many prizes including the prestigious New York Young Concert Artists Competition in 1999 where he was also awarded the Pasadena Symphony Soloist Prize and the Beracasa Foundation Prize of the Montpellier Radio-France Festival. Other honours include First Prize in the Prague Spring Competition in 1998, the 1999 Akzo Nobel Prize, and the prestigious Davidoff Prize, awarded to him in 2000.

He studied at the Ostrava Conservatoire with Monika Taugendlieb and at the Prague Music Academy with Ivan Klánský. He regularly attended courses at home and abroad (Paris, Villecroze, Piestany, České Budějovice, Ostrava) where his teachers have included Lazar Berman, Eugen Injic, Christian Zacharias, Paul Badura-Skoda, Claud Herffel and Pierre Jasmin.



Martin Kasik

"...They are high-powered performances, technically brilliant and freely expressive..."
"...In the bravura writing he is strong, fiery and impulsive..."

--Edward Greenfield, The Gramophone, January 2005

PROGRAMME

- | | | |
|-----------|---|---|
| F. CHOPIN | - | Scherzo in B-flat Minor Op 31 |
| | - | Mazurkas Op 24 |
| | - | Andante Spinato et Grande Polonaise Brillante Op 22 |

INTERVAL A glass of wine or juice will be served to you in your seats during the interval

- | | |
|----------------|---------------------------|
| M. MUSSORGSKY- | Pictures at an Exhibition |
|----------------|---------------------------|

BOOKING FORM

TERMS AND CONDITIONS

Booking Seats

You should order using the form in this brochure (or print one from our website). You can also phone and book using a credit card or debit card. Many of our seats are booked within a few weeks of the brochure going out, so please try to book early. We do not normally send out tickets, but ask you to retain your acknowledgement letter instead. If should you lose it, do not worry as we have all of the information on file. If you would like separate tickets to pass on to guests, please mention this on the phone or in the booking form. As a rule, we do not make refunds, but may be prepared to resell attractive seats for concerts where there is a high demand for seats. We always appreciate it when people do inform us if they cannot make it to a concert.

Donations and Charitable Gift Aid

Music at Leamington Hastings is a charity and the voluntary donation element is very important to us. We do not receive any grants or public subsidies and your generosity is therefore very important. This allows us to claim tax-relief on donations made, and in doing so, helps us to pursue our charitable aims and maintain our musical standards. So please, if this applies to you, complete the relevant section of the order form. This also applies if you book initially by phone. You only need to fill the form in once, as long as you keep us informed of change of address and tell us if you cease to pay enough tax in a year to cover your donation. It is important that you do inform us if this is the case.

Changes to the Programme

We reserve the right to change the programme, by substituting one work by an equivalent work, or substituting artists. This will be done primarily at the behest of the artists, if for example a certain work requires a specific player and they are ill. This is quite rare.

Consult Website for the most up-to-date Information

All printed information is correct at the time of going to press. Any changes will be minor and will be reflected on the website. In the unlikely event of a concert time or date changing, we will do our best to inform those who have booked already by post or email, as appropriate. Clearly, this is one of many reasons to let us have your email address.

Note:- you can book by phone, but please also complete sections 1 and 4 and return the form

1. Your Details

if you have friends who would like a brochure - please let us know. You can phone, email, or enclose their details with this form. All information is also available on the Website (see below)

Title & Name
Address & Post Code

Contact telephone number
Email

2. Number of Seats Required

We are seeking to keep the ticket prices at the same level as previous years; for example, £8 a standard ticket. In addition we would like to suggest a donation of £8 for each ticket purchased (except for the Matinee on June 9th)

1. Saturday May 25th 7.30

Kammer Philharmonie Europa

2. Saturday June 8th 7.30

Atea Wind Quintet

3. Sunday Matinee June 9th 3.00PM*

4. SUNDAY July 14th 7.30

Yehudi Menuhin School Orchestra

5. Saturday September 7th 7.30

Martin Kasik (piano)

6. Saturday October 12th 7.30

St Petersburg String Quartet

7. Saturday December 7th 7.00

Ex Cathedra

	Adult (£8+£8 assuming Sug'd donation)	Youth (<18) (£2 + £8 sug. donation) – more than 1 go free if accompanied by adult	Total Amount in £ pounds	Of which Donation is £ pounds
	<input type="checkbox"/> @£16	<input type="checkbox"/> @ £10 1st only		
	<input type="checkbox"/> @£16	<input type="checkbox"/> @£10 1st only		
	<input type="checkbox"/> @£8	<input type="checkbox"/> @£2		
	<input type="checkbox"/> @ £16	<input type="checkbox"/> @ £10 1st only		
	<input type="checkbox"/> @ £16	<input type="checkbox"/> @ £10 1st only		
	<input type="checkbox"/> @£16	<input type="checkbox"/> @ £10 1st only		
	<input type="checkbox"/> @ £16	<input type="checkbox"/> @ £10 1st only		
	<input type="checkbox"/> Or £12, for chancel, £4+8	<input type="checkbox"/> No reduction for chancel		
Season Ticket for all 6 main concerts	<input type="checkbox"/> @ £78 each (£38 +£40 donation)			
Grand Total				
	<input type="text" value="3"/> @ £16	<input type="text" value="2"/> @ £10 for 1st	48+10=58 (to pay)	24+8=32 (donation)

EXAMPLE 3 adults+2 children May 25th, assuming the donations as suggested

3. State Seating Preferences and Other Special Requirements * no reserved seats at Matinee

Please state, in the box below, your seating preferences. *Please try and be as general as possible*, e.g. if you want a central aisle seat, say exactly that, rather than pick a particular seat. Negative preferences are useful too. In addition, if separate tickets are required for one or all concerts, instead of the usual confirmatory letter, request this below too. **IF YOU NEED WHEELCHAIR ACCESS PLEASE OR DISABLED PARKING PLEASE Telephone / email 2 weeks beforehand**

--

4. Gift Aid Declaration

Please treat donations made above and hereafter, or until I say otherwise, as Gift Aid Donations. I confirm that I pay an amount of UK income tax or capital gains tax equal to or greater than the amount donated to Music at Leamington Hastings (please sign and date below)

Signed _____ and Dated:- _____

5. Payment Details & Contact Details

Cheques should be made payable to: Send to:

David Potts
Music at Leamington Hastings
1 Bawmore Road
RUGBY

If you wish to pay by credit or debit card please complete the section below.

Telephone: **CV22 7QH**
Website: **07966 584 328**
Email: **www.musicatleamingtonhastings.co.uk**
dpotts@musicatleamingtonhastings.co.uk

6. Your Debit/Credit card details (if you wish to pay by this method)

Card No. _____	
Expiry date _____	3–digit Security Code _____
	Issue no. (Maestro) _____ Date Valid From (Maestro) _____

Music at Leamington Hastings

Entry from the Charity Commission web site describing
our activities

**PROMOTING CLASSICAL MUSIC CONCERTS
IN AID OF THE VILLAGE AND CHURCH OF
LEAMINGTON HASTINGS, AND ENCOURAGING
YOUNG PEOPLE IN PERFORMING AND
EXPERIENCING CLASSICAL MUSIC.**

Concert 6

October 12th Saturday 7.30pm



St Petersburg Quartet

Alla Aranovskaya
Evgeny Zvonnikov
Boris Vayner
Leonid Shukaev

The St. Petersburg Quartet is one of the world's most esteemed chamber ensembles. Their rise to fame has included a Grammy nomination, "Best Record" honours in both Stereo Review and Gramophone, an opening night performance at Mostly Mozart at Lincoln Center, a five-year residency at the Oberlin Conservatory of Music, and hundreds of concerts at several of North America, Europe and Asia's most prestigious series and festivals.

Founded in 1985 as the Leningrad String Quartet, the SPSQ blazed a trail through chamber music world. They have won a number of prestigious international competitions including 1st Prize at the All-Soviet Union String Quartet Competition; Silver Medal and a Special Prize at the Tokyo International Chamber Music Competition, 1st Prize and both Special Prizes at the Vittorio Gui International Competition for Chamber Ensembles in Florence, Italy, and First Prize and the "Grand Prix Musica Viva" at the Melbourne, Australia International Chamber Music Competition.

PROGRAMME

D. SHOSTAKOVICH - String Quartet No 1 in C Major, Op 49
A. BORODIN: - Quartet No 2 in D

INTERVAL A glass of wine or juice will be served to you in your seats during the interval

P.I. TCHAIKOVSKY - String Quartet No 1 in D Op 11 (1871)

Concert 7

December 7th Saturday 7.00pm - NOTE EARLY START



Ex Cathedra has established an international reputation as a leading UK choir and Early Music ensemble, with a repertoire that ranges from the 12th to the 21st centuries, via almost all points in between. They aim to explore, research and commission the finest choral music and to set the highest standards for excellence in performance and training. They have become known for our passion for seeking out the best, the unfamiliar and the unexpected in the choral repertoire, for giving dynamic performances underpinned by thorough research, and for our commitment to new music

Ex Cathedra

Directed by
Jeffrey Skidmore

Jeffrey Skidmore's reputation as one of the UK's leading choral directors and an ardent advocate of the importance of singing in people's lives today is rooted in his work with Ex Cathedra, the choral ensemble he founded over 40 years ago in his home city of Birmingham. Jeffrey's driving passion has been to refresh and reinvigorate the choral repertoire and to make it accessible to as many people as possible, both now and in the future.

From Ex Cathedra 2012/13 Programme advertising their concerts at St Pauls, Birmingham.....

“....These concerts are aimed at the heart of Christmas. A sequence of beautiful music from around the world and across the ages, combines seasonal favourites with hidden gems. The music will be interspersed with an equally varied selection of readings, both humorous and thought-provoking. Lit by candlelight, there is a very special atmosphere. Early booking is recommended...”

If you look at the Birmingham prices you will see the value we offer - and in Birmingham you have to bring your own mulled wine and mince pies!

..... but early booking is still essential

DIARY



Leamington Music Winter Series 2012/13

Sunday 3 February at 3pm Bridge House Theatre Warwick
Ensemble 360

Beethoven Duo in C WoO.27 No 1, Britten Three Divertimenti, Charlie Piper
Jacaranda and Mozart Clarinet Quintet in A K581
2.10pm Pre-concert talk

Tuesday 19 February at 7.30pm St Mary's Church Warwick
James Gilchrist tenor and Peter Seymour fortepiano
Schubert's Die Winterreise

Friday 22 February at 7.30pm Royal Pump Rooms Leamington Spa
Skampa String Quartet

Mozart Quartet in B flat K589, Kapralova Quartet No 1 and Beethoven Quartet in
E flat Op 74 The Harp

Sunday 24 February at 11.30pm Bridge House Theatre Warwick
Family Concert (designed for 7+) - *Onyx Brass*

Sunday 24 February at 3pm Bridge House Theatre Warwick
Onyx Brass

Music by Monteverdi, Holborne, Bach, Shostakovich, Copland, Gabrieli, Ives,
Cheryl Frances-Hood, Timothy Jackson and Arnold.
2.10pm Pre-concert talk

Leamington Music Festival Weekend 3 to 7 May 2013

The highly acclaimed weekends of music built round the first of the May Bank Holiday Weekends date back to 1990. We turn to British music in 2013 as we celebrate the centenary of the birth of Benjamin Britten.. Among other composers featured are Ireland and Bridge with whom he studied plus Bax, Bliss, Elgar, Finzi, Gurney, Howells, Moeran, Quilter, Simpson, Stanford, Vaughan Williams and Walton. *Artists invited include the Sacconi, Coull, Fitzwilliam and Carducci String Quartets, the London Soloists Ensemble, Hepplewhite Piano Trio, Leonore Piano Trio, pianists Anna Tilbrook, Mark Bebbington, Joseph Middleton, David Quigley, plus David Campbell and Jack O'Neill clarinets, Nicholas Daniels oboe and singers Nicholas Mulroy and Roderick Williams.*

Full details will be available by the end of January and booking will open during February. Call 01926 776438 or online www.bridgehousetheatre.co.uk

Booking Seats

You should order using the form in this brochure (or print one from our website). You can also phone and book using a credit card or debit card. Many of our seats are booked within a few weeks of the brochure going out, so please try to book early. We do not normally send out tickets, but ask you to retain your acknowledgement letter instead. If you would like separate tickets to pass on to guests, please mention this on the phone or in the booking form. As a rule, we do not make refunds, but may be prepared to resell attractive seats for concerts where there is a high demand for seats. We always appreciate it when people do inform us if they cannot make it to a concert.

Donations and Charitable Gift Aid

Music at Leamington Hastings is a charity and the voluntary donation element is very important to us. We do not receive any grants or public subsidies and your generosity is therefore very important. This allows us to claim tax-relief on donations made, and in doing so, helps us to pursue our charitable aims and maintain our musical standards. So please, if this applies to you, complete the relevant section of the order form. This also applies if you book initially by phone. You only need to fill the form in once, as long as you keep us informed of change of address and tell us if you cease to pay enough tax in a year to cover your donation. It is important that you do inform us if this is the case.

Getting to the Church

Once you get to the village of Leamington Hastings, the church is located as shown below.

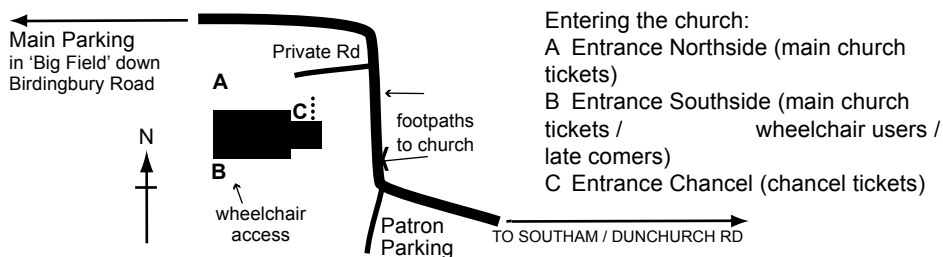

Main Parking

This is off-road in a field. This is the country side so bring suitable footwear as the weather dictates. When its very wet we do the best we can, but parking requires care.

Patron and Disabled Parking

This is closer to the church. It is a short walk, but the comments about bad weather still apply. You need a pass, a 'disabled' badge, or prior permission to park here.

Arriving in Time

There is a 5 minute walk from the car-park to the church. It is best to aim to park around 15 minutes before the concert starts.

Intervals

Depending on the weather we go to a nearby garden, (thanks to generous neighbours), or we stay in the church. There is always some refreshment provided by our volunteers - see each concert for details.

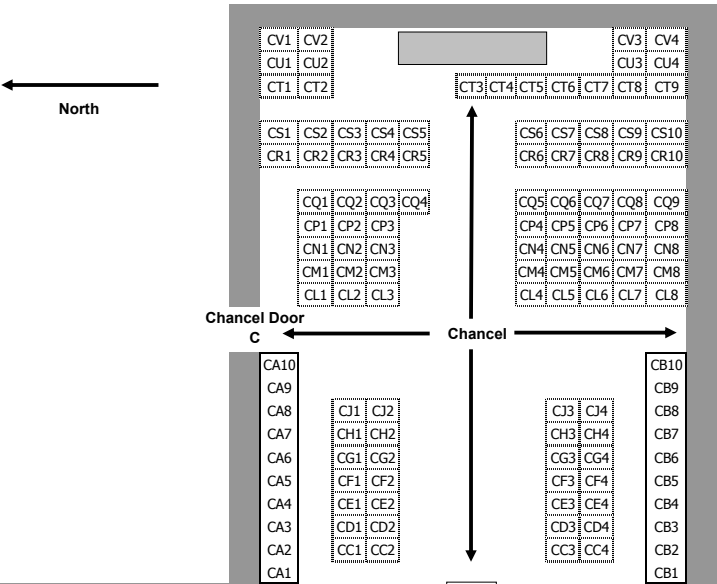

All Saints Church
Layout of Seats
for Concerts

Please note
 seats A8-A12
 A16-A20 may
 actually be plastic
 chairs depending on
 circumstances - so
 avoid if you need a
 pew to sit on

- = bench seating [see above](#)
- = plastic seat
- = pillar or other obstruction

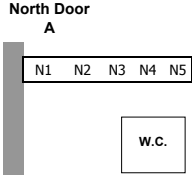
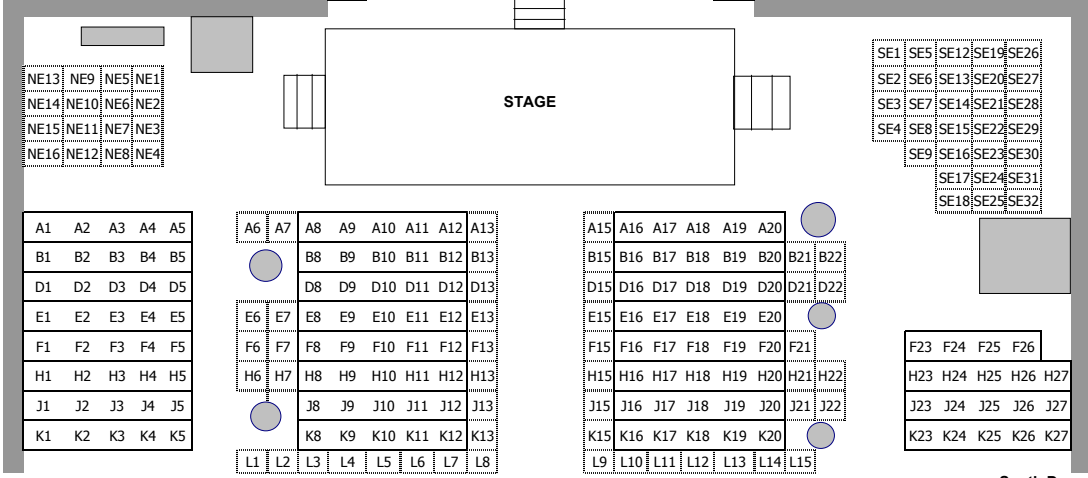

Wheelchair Access

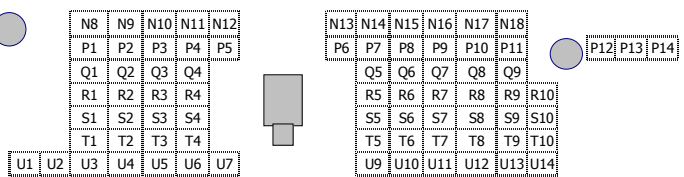

Gallery - Up Spiral Stairs

Music at Leamington Hastings

Registered Charity 1121192

President - John Lill CBE

Concert Helpers

It would be impossible to hold these concerts without the people who prepare the refreshments, serve them, feed the artists, erect the stage, clear everything away, arrange the flower, sell tickets and programmes, act as ushers, provide car parking, manage the car parking and lighting, provide photographs, write the programme notes, accomodate artists when necessary, help with distributing leaflets. audit the accounts, provide and move (!) pianos. and perform a myriad of other tasks behind the scenes In no particular order

Chris & Carmel De Nahlik
Peter & Ann Coulson
Dr Christine O'Brien
Peter & Mary-Grace Ogilvie
Gillian Potts
David & Valerie Smith
Gordon Smith
Zinnia & Adrian Allen
Lars Maynard
Steve Gee
Nick Turner
David Turner
Eugene Dixon
Maurice Greenaway
Wallace & Josie McCurdie

Jenny & Alan Broadbent
Colin & Ruth Bemrose
David & Patricia Biddle
Rose Hull
Gwyn Davy
Karen Hatch
Heather Hemelryk
Gillian Wilson
Sandra & Graham Rice
Di Weaver
Anne Molyneux
Stewart Harris,
Fiona Morton
Mary Ballard
Jeannie Williamson,

Doreen Wadland
Joan Elliot
Lorraine Dimpleby
Mary Fields
Jan Cockerill
John & Katie Fisher
Sue & John Middleton
Marie & Melvyn Warren-Smith
Rev'd Jane Close
Brian Cooke
Martin Jackson
Kay Reeve

Patrons of Music at Leamington Hastings

Patrons help by contributing a regular donation, taking a role in guiding the direction of the Charity, and helping in other ways. Once again we would like to express our gratitude to all our patrons for their encouragement and support, including:

Dr & Mrs Backhouse
Mr & Mrs Alan Buckle
Mrs E J Burton
Mr & Mrs Peter Coulson
Miss Helen Forster
Mr & Mrs Peter Galliford
Mrs K Gibson
Mr & Mrs K.J.Hall
John & Sharon Hancock
Mrs S A Haswell
Mr & Mrs Roy Hatch

Mrs Helen Hoggarth
Mr & Mrs C Johnson-Ferguson
Lord & Lady Judge
Mr & Mrs P Kander
Mr & Mrs Kenworthy-Browne
Mr & Mrs Ray Law
Mr Patrick Liddell
Dr Christine O'Brien
Mr & Mrs Peter Ogilvie
Mr & Mrs Tom Pedrick
Mr John Peirson

Gillian & David Potts
Mr & Mrs Michael Rayner
Mr & Mrs David Smith
Mr Brian Southern
Mrs Hazel Steven
Mrs Patricia Wakeford
Mr & Mrs P Watts
Mrs Di Weaver
Mr B W Young

Patrons can come to the annual general meeting, discuss forward-planning of concerts, have opportunities to meet the artists if we hold a reception on the day of the concert, and have priority use of the church car park, If you would like to contribute by being a Patron please contact David Potts who will arrange matters.

History of Music at Leamington Hastings

The Concerts

The 'Ray Law' concerts began in 1971, as a personal project of the Law family.

By 1980 the concerts had become well established, and 1982 saw the first visit of the Yehudi Menuhin School Orchestra, leading to a long and happy association. Over the next 20 odd years Ray built up the reputation of the concerts, and today Leamington Hastings is well known as a popular venue by many leading musicians. After managing the concerts for over 33 years, Ray Law retired and Mary-Grace and Peter Ogilvie carried on his traditions till 2010. Now David Potts aims to carry this on from 2011, with support from others, in the village and beyond.

John Lill has been one of our most regular and popular performers, and we are honoured to have him as our President. In 2007 we became a registered charity, seeking to promote music in Leamington Hastings, to give young people the opportunity to experience world class music, and to give talented young musicians opportunities to perform. Quite a few of the major 'stars' who have played for us over the years first visited Leamington Hastings as pupils of the Yehudi Menuhin School.

The Church

'There belongeth to the said parish of Leamington Hastings three towns standing all upon manors and great farms of husbandry. Leamington, the parish town, where the church standeth, and the Parsonage house with all other edifices most fair and beautiful. These belongeth to the same church, and a great village of husbandry called Broadwell, and another husbandry called Hill; another village of most fruitful soil called Kites Hardwick, where the parson hath one hundred acres of glebe land ... of most fruitful arable and pasture grounds.'

This beautiful church dates from the 12th century. The two features that stand out most, as far as the concerts are concerned, are the excellent acoustics, and the very long chancel (behind the stage).

The acoustics have aroused favourable comments from many musicians, being ideally suited to chamber music. We believe that the main factor influencing this is the oak-panelled ceiling in the nave, which was installed during a refurbishment by Giles Gilbert Scott in the late 19th century. The long early English chancel is believed to have originally been built in the 13th century for the 'Black Canons', who came from the Augustinian Priory of St Oswald's in Yorkshire. The chancel was completely destroyed in the mid 17th century, thought to be the work of the roundheads after a battle at Southam, around the time of the Battle of Edgehill. It was rebuilt again some 30 years later, and has been a feature of the church ever since.

A substantial refurbishment of the tower and all the parapets and high level stonework was completed prior to the fire at the end of 2009. English Heritage gave a small amount towards the £125,000 cost, but most of the funds have come from other sources, and everyone involved with the church is immensely grateful to the Patrons and the concertgoers of Music at Leamington Hastings for the substantial contributions they have made. In 2010, following the fire, the church has been repaired and refurbished, and in 2011 we returned gratefully to concerts in the church.

The population of Leamington Hastings is about the same size as that recorded in the Domesday Book, and planning restraints mean that it is unlikely to grow – it is likely to remain a peaceful rural place, heavily dependent on visitors to support these concerts.



TICKETS & ENQUIRIES

Music at Leamington Hastings

David Potts

1 Bawnmore Road

Bilton, Rugby

CV22 7QH

dpotts@musicatleamingtonhastings.co.uk

07966 584 328

www.MusicAtLeamingtonHastings.co.uk

